

SD90

50Hz 949-0526-07
 Mono 60Hz 949-0526-06
 50Hz 949-0586-02
 Tri. 50Hz 949-0526-85 AEG
 60Hz 949-0526-03

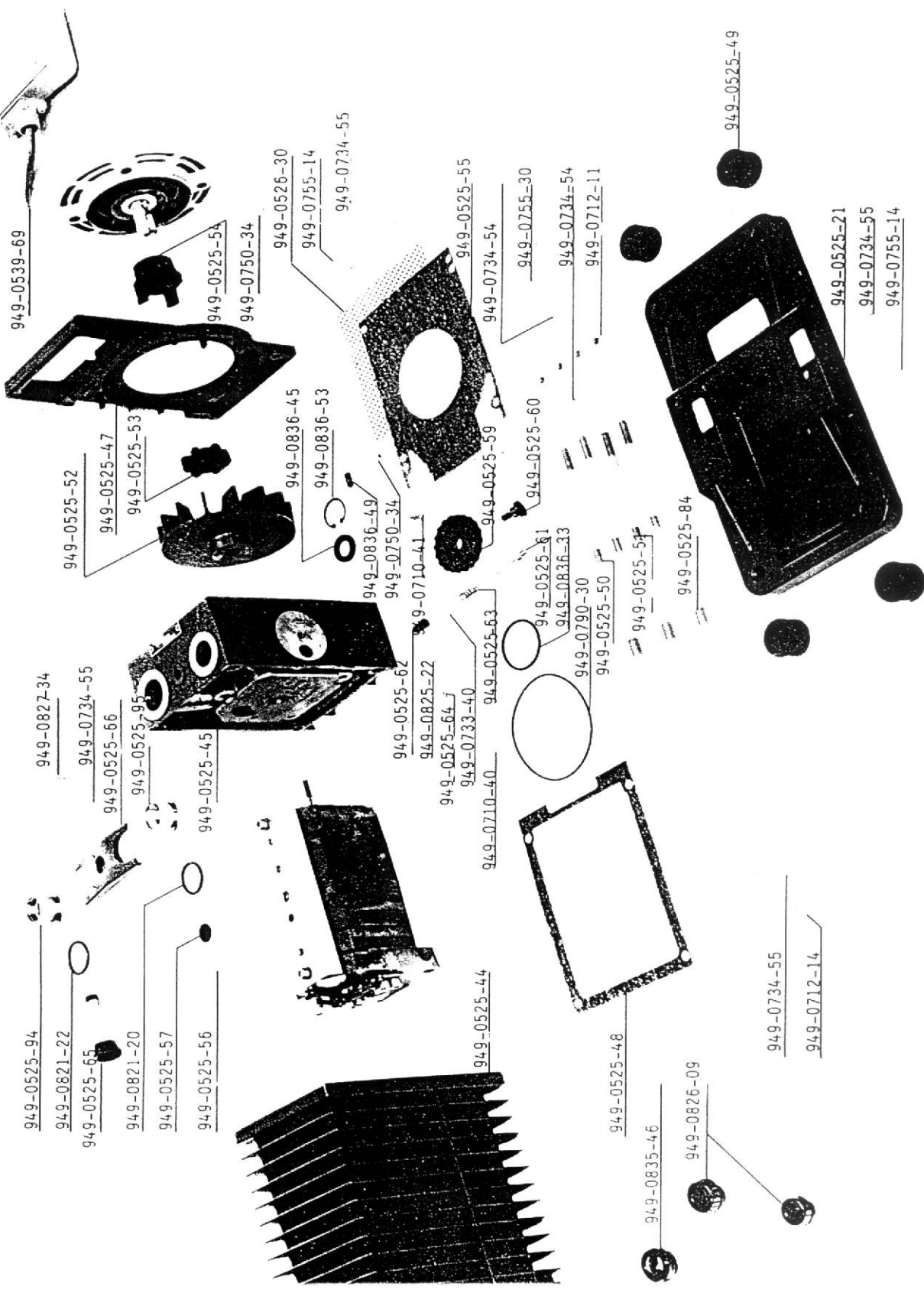

SD90

949-0837-72



949-0755-08

949-0734-54

949-0525-39

949-0525-41

949-0525-40

949-0525-75

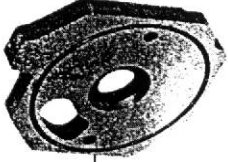

949-0525-41

949-0525-40

949-0525-13



949-0525-72

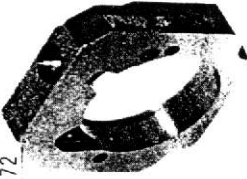

949-0836-45

949-0710-40

949-0839-46

949-0530-40

949-0790-30

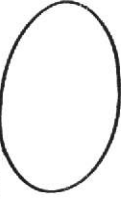

949-0525-10



949-0755-09

949-0525-70

949-0831-30

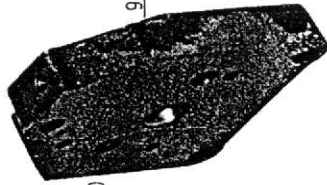

949-0525-71

949-0839-46

949-0530-40



949-0836-45

949-0710-40

949-0836-53



949-0821-05

949-0526-77

949-0525-69

949-0734-54

32-90

949-0755-08

949-0734-54

949-0755-08

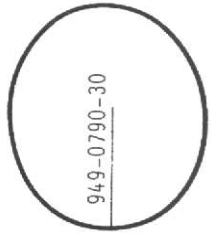

949-0790-30

949-0836-45

949-0525-72

949-0710-40

949-0534-74

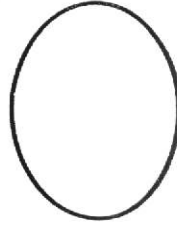
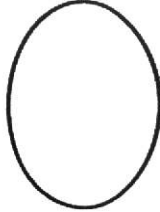

949-0821-05

949-0526-77

949-0525-69

949-0734-54

949-0734-54

949-0755-08

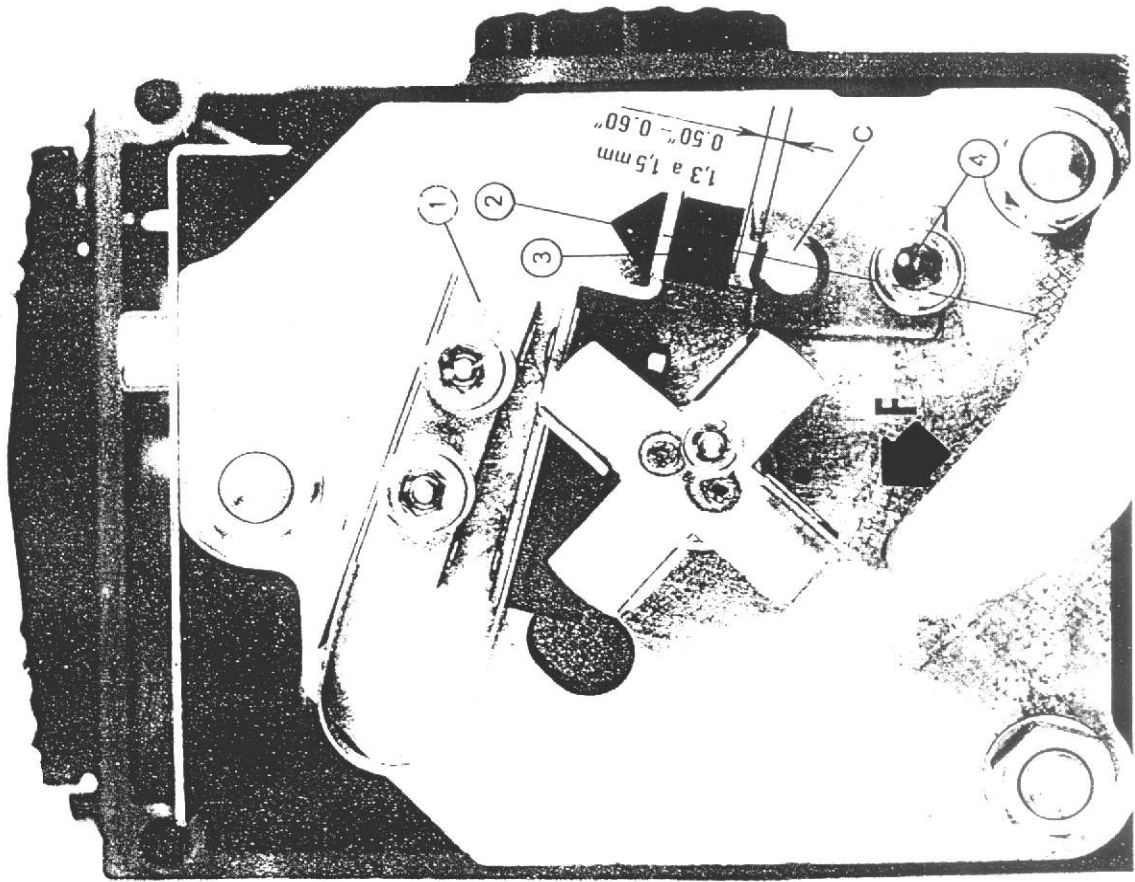

B

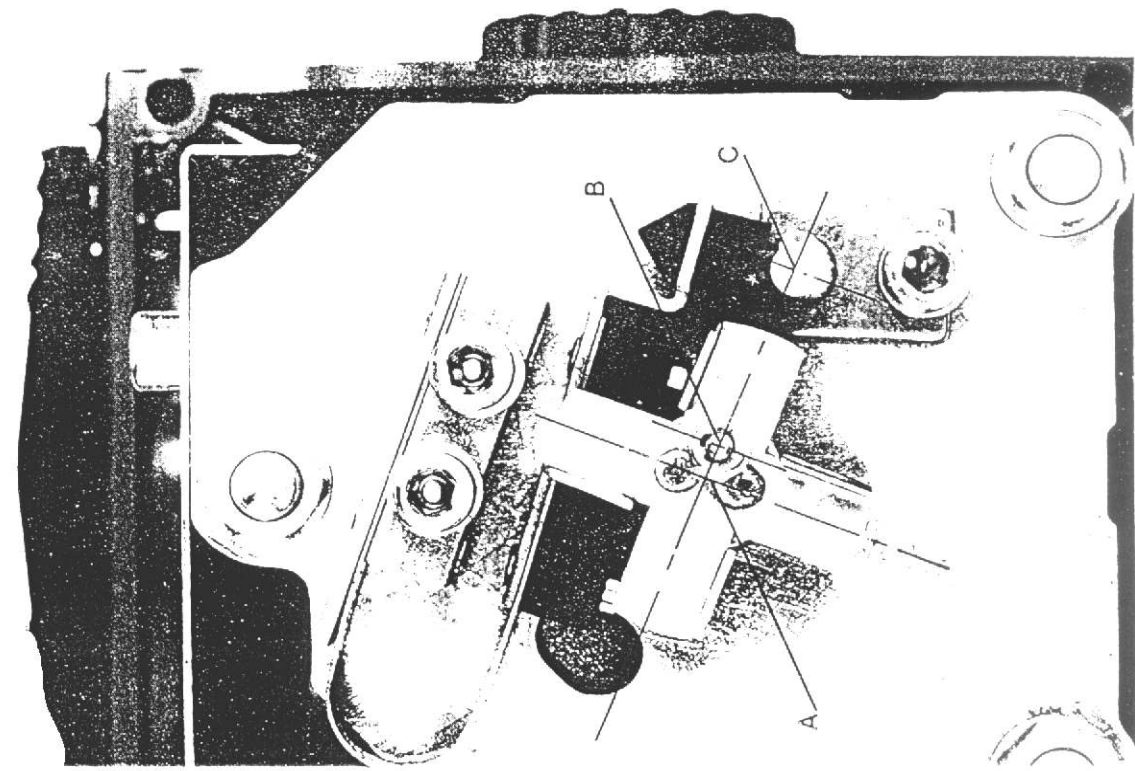

A

FIGURE 04
ADJUSTEMENT OF ANTI-SUCKBACK VALVE ASSY. (see 3.3.4.)